

# JAM-STONE™

## Hand-Rail & Cap Installation Guide

### STEP 1

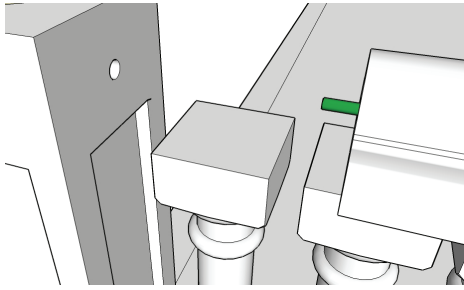

Laying out of the handrail should be done prior to installing any pieces. Some cutting may be necessary to install pieces equal/equal. Never leave a 2" piece.

Drill a 1" hole in the end of the handrail that will attach to the newel post. Insert dowel/rebar into the handrail using concrete adhesive. Drill out the newel post to receive dowel and apply concrete adhesive to hole. Set rail in place using adhesive on the top of each baluster.

### STEP 2

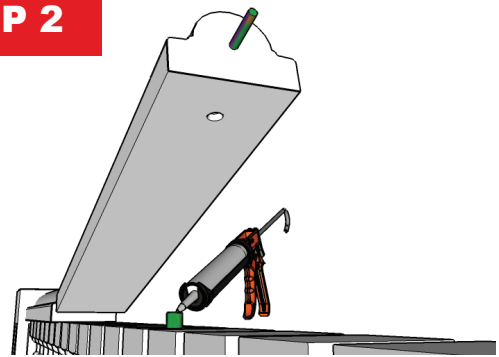

Each handrail should be doweled to one another following the same steps you did for the handrail to the newel post. Additionally, the handrail should be doweled to 1 baluster for each section of handrail.

### STEP 3

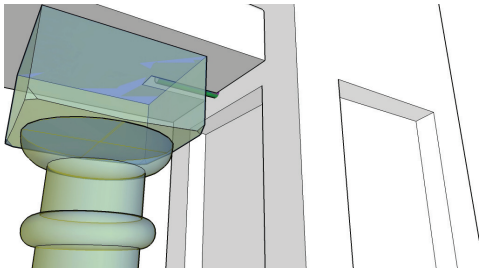

**Repeat step #2** for each section of handrail. The final piece of handrail should be notched at the end, so the handrail sits on the dowel which is inserted into the newel post first. Now all your components are not only "glued" together, but mechanically fastened.

### STEP 4

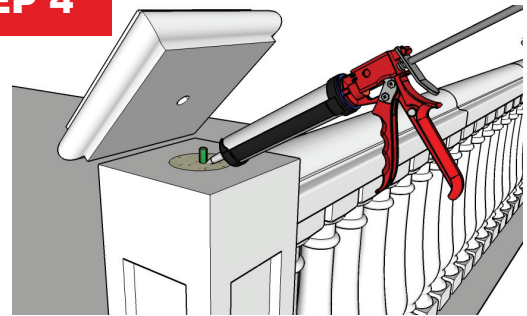

Finish each newel post by drilling a 1" hole on the under side of the cap and secure it to the post using concrete adhesive. The cap should sit over the rebar that protrudes from the top of the newel post. This will lock the cap onto the newel post shaft.

### STEP 5

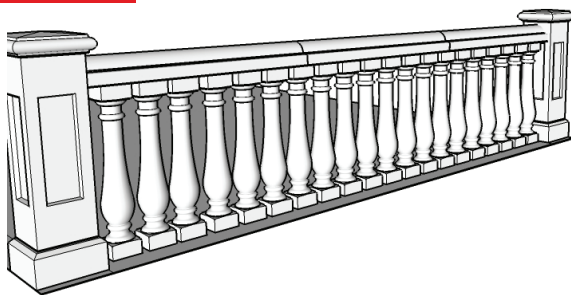

Finish the installation by grouting joints and patching any imperfections/chips that may have happened during installation. Wipe off excess grout with a wet sponge and keep the stone as clean as possible.

### STEP 6

Sealers may be applied after the installation is complete and all material is dry. There are a wide range of choices, the wet look, neutral, etc... Check Out the Jam-Stone website or check with your local building supply company.

**Note:** All sealers should be breathable as concrete constantly cures.